

Instruction for Umbrella Bucket Assembly

CONTENT

1. Tool Preparation.....	2/7
2. Materials for Umbrella Bucket.....	3/7
3. Umbrella Bucket Disassembly (Diagram).....	4/7
4. Umbrella Bucket Disassembly (Procedure).....	5/7
5. Umbrella Bucket Assembly (Diagram)	6/7
6. Umbrella Bucket Assembly (Procedure).....	7/7

Installation Steps:

Diagram----- Tool Reference



Procedure----- Tool Reference

Tool Checklist

1. Electric Screwdriver + Hex Bit
2. Hex Bit (Manual Use)
3. Phillips Screwdriver

Installation Steps

Diagram----- Materials



Procedure----- Materials

Materials Checklist:

1. Extended Umbrella Bucket Assembly – 1 PCS
2. 4.8x12 Phillips Pan Head Self-Tapping Screws – 3 PCS

Installation Steps:

Diagram ----- Umbrella Bucket Disassembly

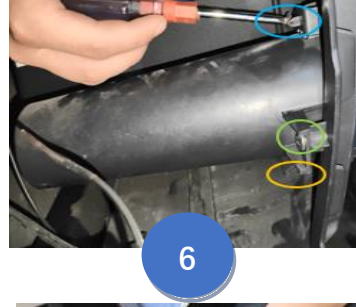
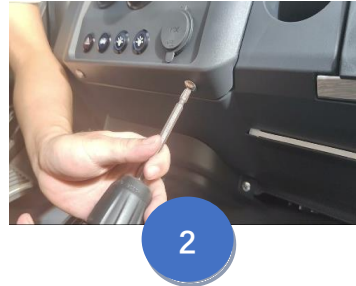
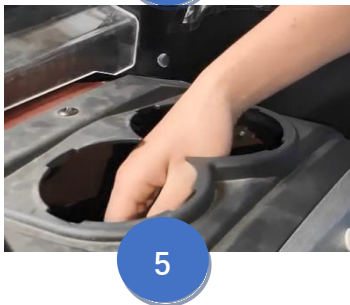
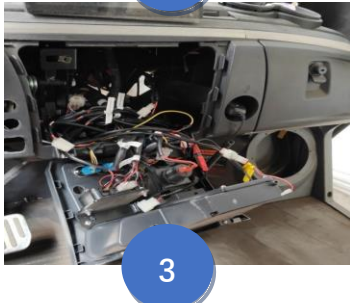

Installation Steps:

Operation Procedure ----- Umbrella Bucket Disassembly

Operating Procedure

Follow the steps below in sequence:

1. **Disassemble the upper section of the control panel:** Use an electric drill with a Phillips bit to loosen and remove the Phillips screws located at the top of the control panel.
2. **Disassemble the lower section of the control panel:** Use an electric drill with a Phillips bit to loosen and remove two sets of Phillips screws located at the bottom of the control panel.
3. **Inspect the result after control panel removal.**
4. **Remove the cup holder on the passenger side.**
5. **Reach downward through the cup holder mounting opening:** Using a Phillips screwdriver, loosen and remove three sets of mounting screws located at the top (refer to Diagram 6, light blue circle), middle (refer to Diagram 7, green circle), and bottom (refer to Diagram 8, orange circle) of the umbrella bucket by turning counterclockwise. Remove the umbrella bucket as shown in Diagram.

Installation Steps:

Diagram ----- Umbrella Bucket Disassembly

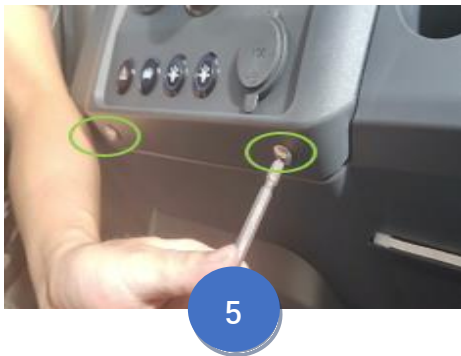
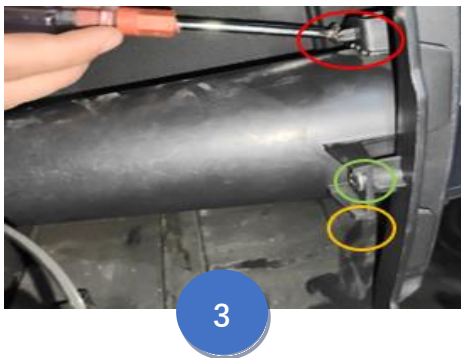

Installation Steps:

Operation Procedure ----- Umbrella Bucket Disassembly

Follow the four steps below in sequence:

- 1. Umbrella Bucket Installation:** Before installation, identify the orientation of the upper, middle, and lower mounting tabs. As shown in Diagram 1 (green circle), the middle tab is a single-hole type and should face the driver's side during assembly.
- 2. Align Mounting Tabs and Screw Holes:** After confirming the mounting tab positions, align the umbrella bucket tab holes with the dashboard mounting holes as shown in Diagram 3. Insert the previously removed screws (see Diagram 2). Reach through the cup holder opening and use a Phillips screwdriver to tighten the screws at the top, middle, and bottom positions of the umbrella bucket (tighten the middle first, then the top, and finally the bottom).
- 3. Reattach the Control Panel to the Dashboard:** As shown in Diagrams 4 and 5 (green circles), insert the three sets of previously removed bolts into the upper and lower mounting holes of the control panel. Use an electric drill with a Phillips bit to tighten and secure them.
- 4. Install the Cup Holder:** Align the cup holder with the designated slot in the mounting opening and press gently to ensure it is properly seated.